

GENERAL HIGHWAY MAP BANNER COUNTY NEBRASKA

PREPARED BY THE
DEPARTMENT OF ROADS
INFORMATION SYSTEMS DIVISION
IN COOPERATION WITH THE
U.S. DEPARTMENT OF TRANSPORTATION
FEDERAL HIGHWAY ADMINISTRATION

1984

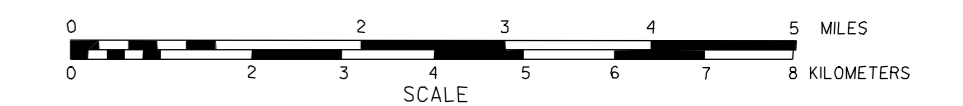

NAME	DATE	REVISION
L. GOSWAMI	OCT. 2001	911 SYSTEM
R. BRAUN	JUNE 2001	ADDITION TO BUFFALO CREEK Wildlife Management Area
D. NELSON	FEBRUARY 2004	HWY 71 DIVIDED
D. NELSON	FEBRUARY 2004	MUDGAT HILLS WMA
D. NELSON	FEBRUARY 2004	REF. POSTS AT CO. LINES
CLAY WILLIAMS	MARCH 2004	EXTENSION OF STATE HWY 84

LEGEND

- Primitive Road.....
- Unimproved Road.....
- Gravel or Crushed Rock.....
- Asphalt/Bituminous Surface.....
- Concrete/Block Surface.....
- Multiple Lane Undivided Highway.....
- Divided Highway.....
- Interstate Highway with Full Control of Access.....
- Side Roads and Streets.....
- 911 NAMED/Numbered Roads.....
- Interstate/Numbered Highway.....
- US-Numbered Highway.....
- State-Numbered Highway.....
- State-Numbered Highway Spur.....
- State-Numbered Highway Link.....
- Highway Reference Post Number.....
- Interstate Exit Number.....
- Wide Stream.....
- Narrow Stream.....
- Irrigation Ditch.....
- Reservoir, Pond or Lake.....
- Reservoir with Dam.....
- Highway Bridge-Any Type over 20' span.....
- Small Bridges-Closely Spaced.....
- Stumps Indicate Trees which bridges are grouped.....
- General Bridge.....
- Arch Bridge.....
- Truss Bridge.....
- Pedestrian Underpass.....
- Railroad Underpass.....
- Railroad.....
- Dam with Road on Top.....
- Cattle Guard.....
- Dwelling.....
- Row of Dwellings.....
- State Capital.....
- Cemetery.....
- Church or Other Religious Institution.....
- Church with Cemetery Adjacent.....
- Business.....
- Industrial Plant.....
- Filling Station.....
- Grain Elevator.....
- Aggregate Pit.....
- Agricultural Experimental Station.....
- Educational Institutions.....
- Public Use Area.....
- Recreational Facilities.....
- Rest Area.....
- Ranger Station.....
- Flah Hatchery.....
- Community Hall.....
- Correctional Institution.....
- Tourist Court or Motel.....
- Monument-Small.....
- Museum.....
- Firestation.....
- Courthouse.....
- Post Office.....
- Highway Maintenance Yard.....
- Dump Area.....
- Sewage Disposal Plant.....
- Water Supply Stand Pipe.....
- Pipe Line.....
- Transmission Line.....
- Power Plant.....
- Radio or TV Station.....
- Pumping Station.....
- Weight Station or Port of Entry.....
- Commercial or Municipal Airport.....
- Airport with Paved Runways.....
- State Boundary.....
- County Boundary.....
- Township Line.....
- Section Line.....
- Corporate Limit Lines.....
- Parks and Other Reservations.....
- Boundary Limits of Area Shown in Enlargements (see enlargements for actual).....
- Other Cities and Villages.....
- Incorporated City or Village.....
- Triangulation Station.....
- Points Between Which Distances Are Measured Indicated Thus.....
- Latitude and Longitude.....

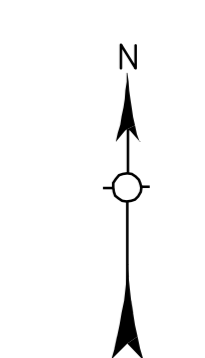
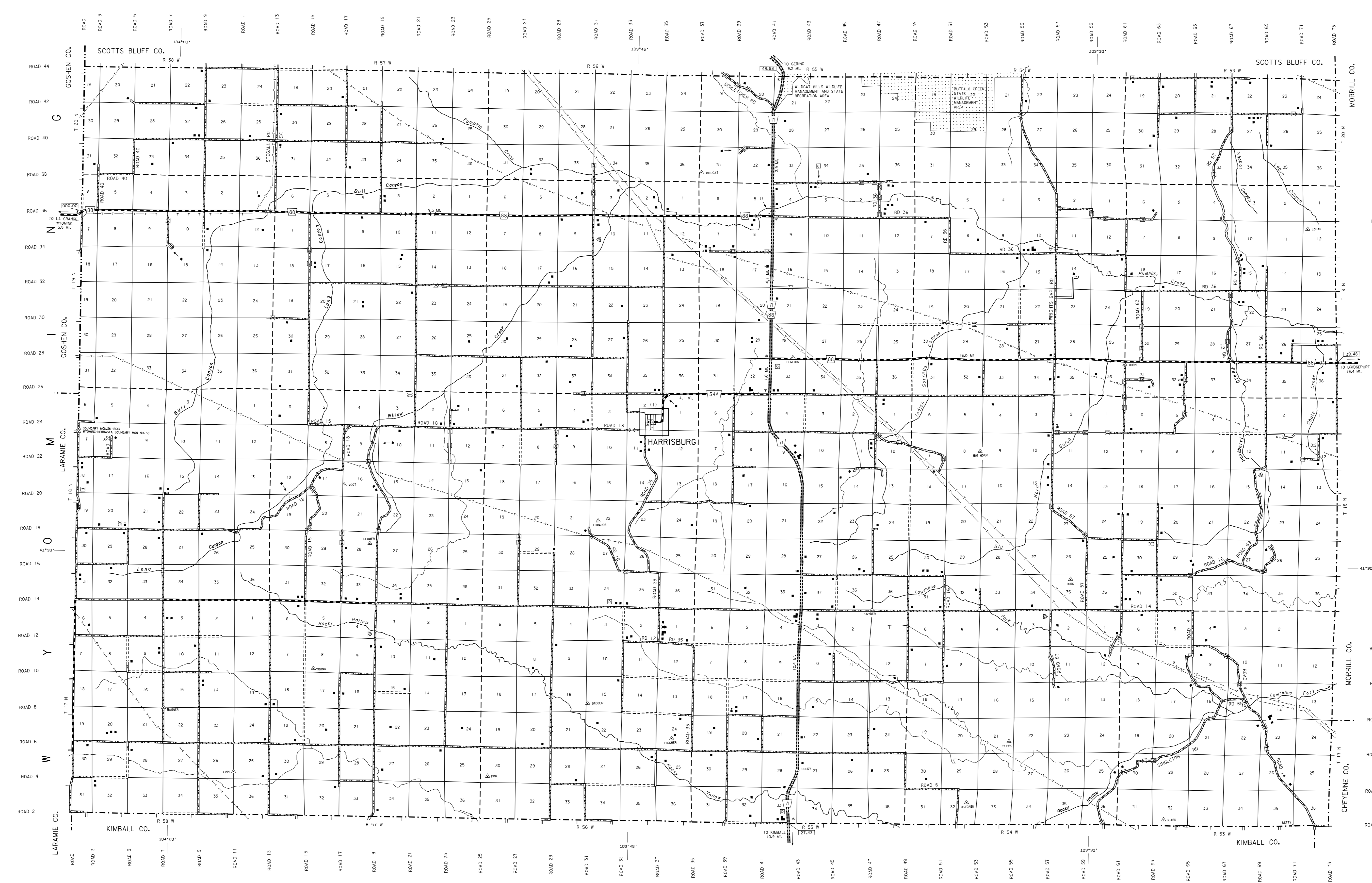
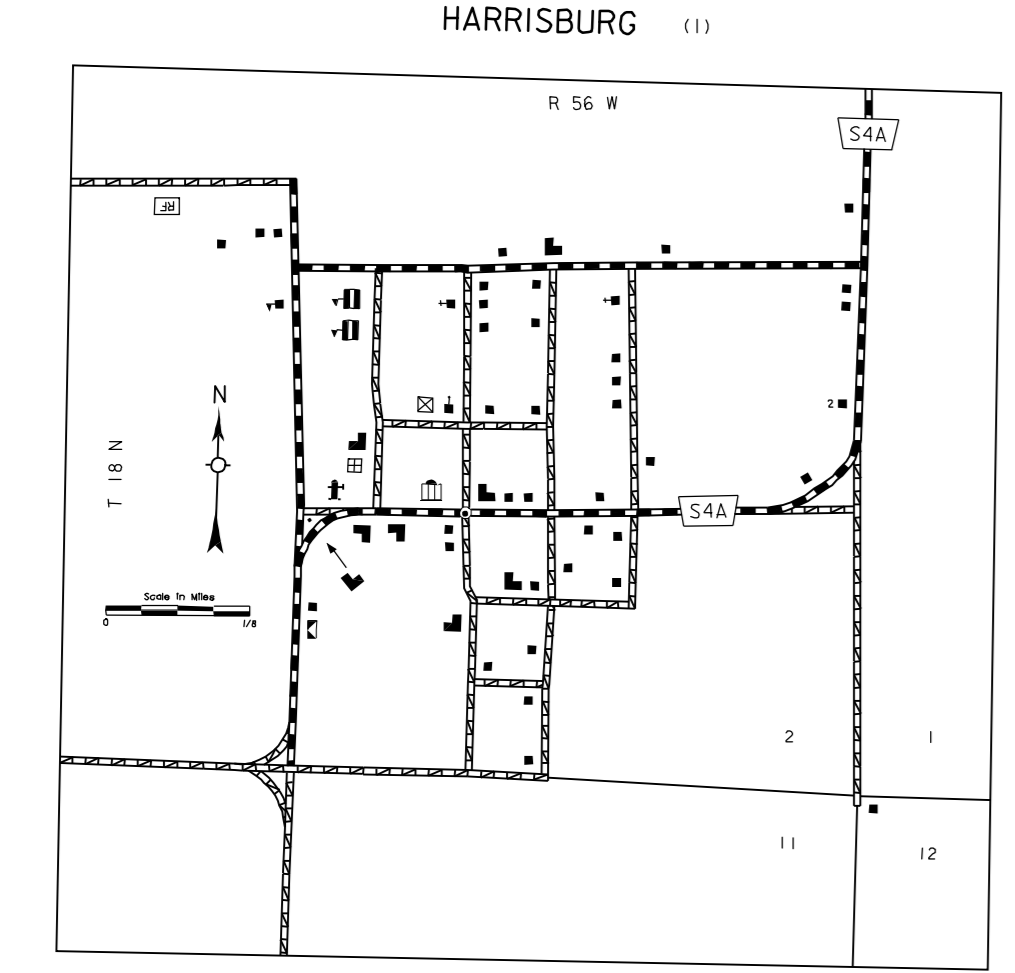

LAMBERT CONFORMAL CONIC PROJECTION
1983 NORTH AMERICAN DATUM
NEBRASKA COORDINATE SYSTEM

