

GENERAL HIGHWAY MAP GRANT COUNTY NEBRASKA

PREPARED BY THE
DEPARTMENT OF ROADS
INFORMATION SYSTEMS DIVISION
IN COOPERATION WITH THE
U.S. DEPARTMENT OF TRANSPORTATION
FEDERAL HIGHWAY ADMINISTRATION



INVENTORY DATE:
1999

NAME	DATE	REVISION	COUNTY
A. WICKLY	JUNE 2000		
GLEN WILLIAMS	DECEMBER 18, 2003	ADD AVOCET WMA	
GLEN WILLIAMS	JANUARY 14, 2004	REVISE AVOCET WMA	
GLEN WILLIAMS	JUNE 22, 2004	ADD SEAFAR LAKE WMA	

LEGEND

- | | | | |
|---|-------|--|-------|
| Primitive Road | | Agricultural Experimental Station | |
| Unimproved Road | | Educational Institutions | |
| Gravel or Graded Road | | Public Use Area | |
| Asphalt/Bituminous Surface | | Recreational Facilities | |
| Concrete/Brick Surface | | Rest Area | |
| Multiple Lane Undivided Highway | | Ranger Station | |
| Divided Highway | | Flash Hatcher | |
| Interstate Highway with Full Control of Access | | Community Hall | |
| Side Roads and Streets | | Correctional Institution | |
| 911 NAMED/NUMBERED ROADS | | Tourist Court or Motel | |
| Interstate-Numbered Highway | | Monument-Small | |
| US-Numbered Highway | | Museum | |
| State-Numbered Highway | | Firestation | |
| State-Numbered Highway Spur | | Courthouse | |
| State-Numbered Highway Link | | Armory | |
| Interstate Exit Number | | Post Office | |
| Wide Stream | | Highway Maintenance Yard | |
| Narrow Stream | | Dump Area | |
| Irrigation Ditch | | Sewage Disposal Plant | |
| Reservoir, Pond or Lake | | Water Supply Stand Pipe | |
| Reservoir, With Dam | | Pipe Line - Present | |
| Highway Bridge - Any Type - Over 20' span | | Transmission Line | |
| Small Bridges - Closely Spaced | | Power Plant | |
| Interments indicate bridge within bridges are grouped | | Power Substation | |
| General Bridge - In view of view - concrete | | Road or TV Station | |
| Arch Bridge | | Pumping Station | |
| Truss Bridge | | Weight Station or Part of Entry | |
| Pedestrian Overpass | | Commercial or Municipal Airport | |
| Railroad Overpass | | Airport with Paved Runways | |
| Railroad Underpass | | State Boundary | |
| Dam with Road on Top | | County Boundary | |
| Cattle Guard | | Township Line | |
| Dwelling | | Corporate Limit Lines | |
| Row of Dwellings | | Parks and Other Reservations | |
| Cemetery | | Boundary Limits of Area Shown in Enlargements - see enlargements for details | |
| Church or Other Religious Institution | | State Capital | |
| Hospital | | County Seat | |
| Business | | Other Cities and Villages | |
| Industrial Plant | | Incorporated City or Village | |
| Filling Station | | Triangulation Station | |
| Grain Elevator | | Points Between Which Distances Are Measured Indicated Thus | |
| Aggregate Pit | | Latitude and Longitude | |

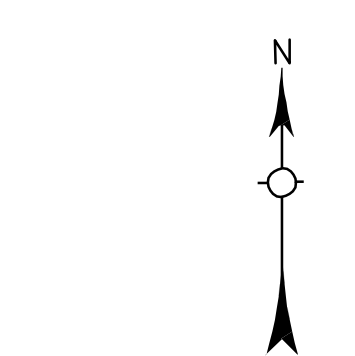
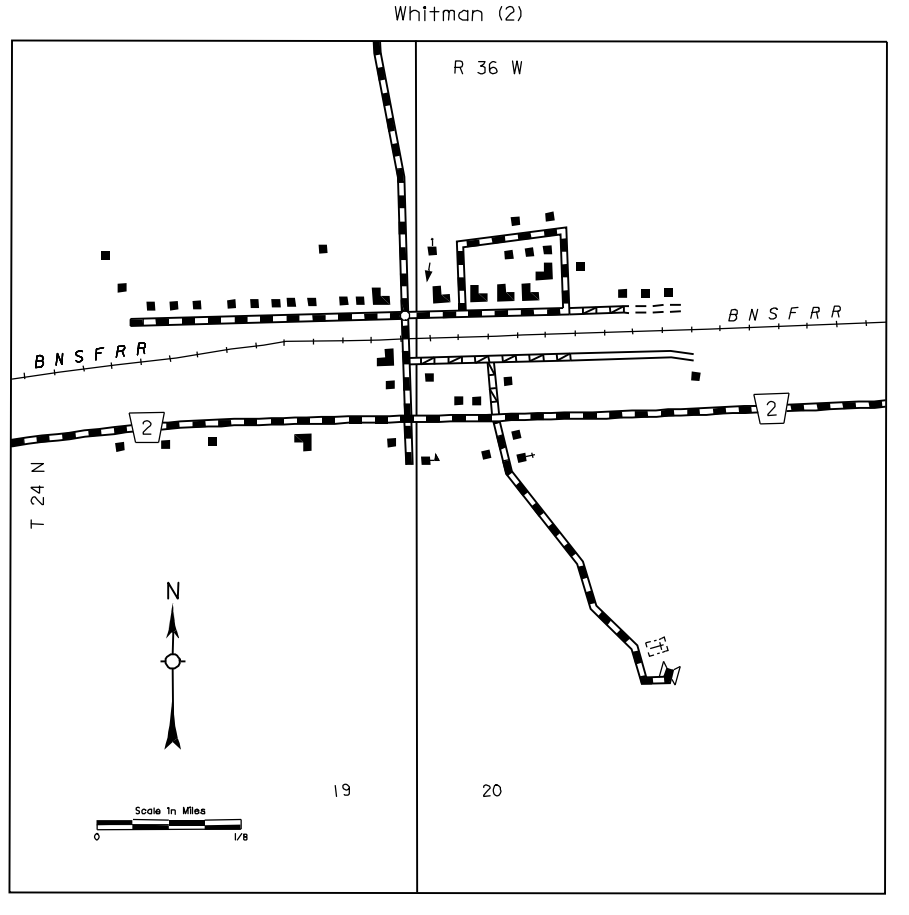
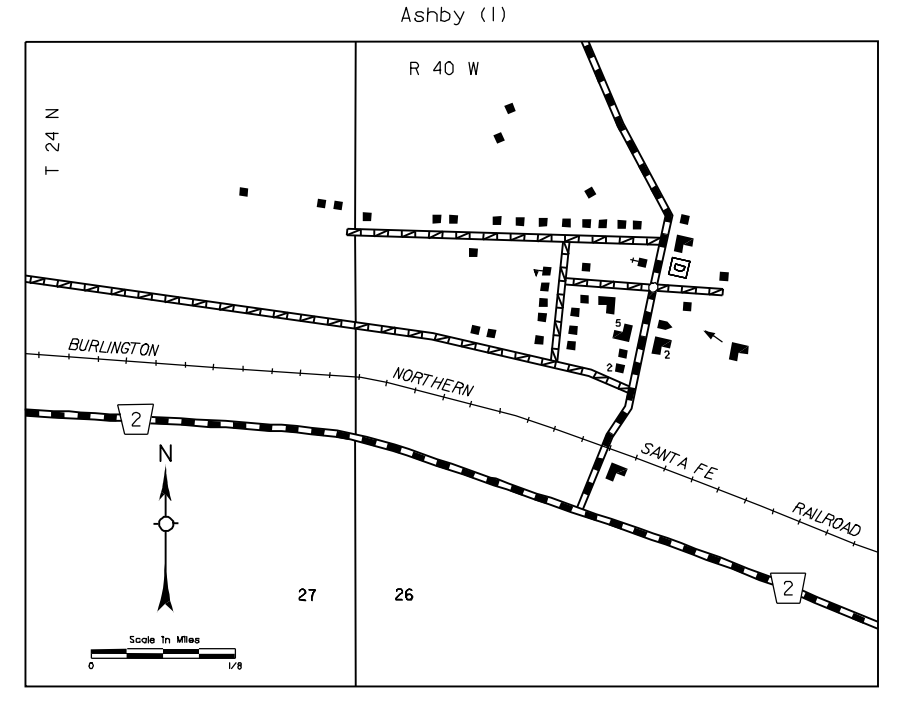
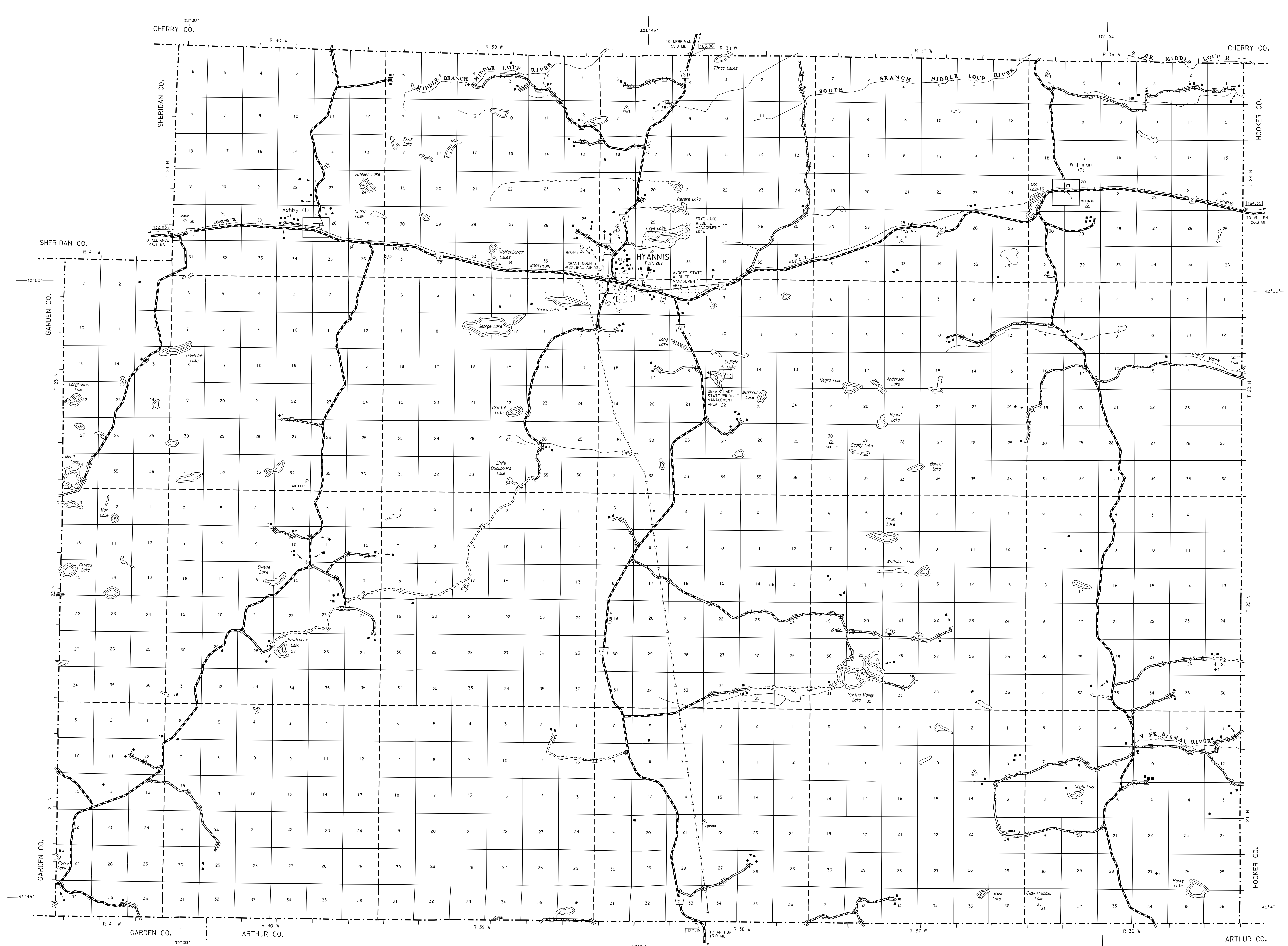

LAMBERT CONFORMAL CONIC PROJECTION
1983 NORTH AMERICAN DATUM
NEBRASKA COORDINATE SYSTEM

